



Zodiac of North America, Inc.  
540 Thompson Creek Rd.  
Stevensville, Md. 21666  
410-643-4141

## Rowlock Support Retrofit using Z60044 / Z60048

If boat has rope lifeline passing through rowlock support, see step A on page 3.  
If boat has no rope passing through rowlock support, proceed with step 1.

- 1) Using a screw driver, with the oarlock receiver in the raised position remove the retaining clip from the axis.

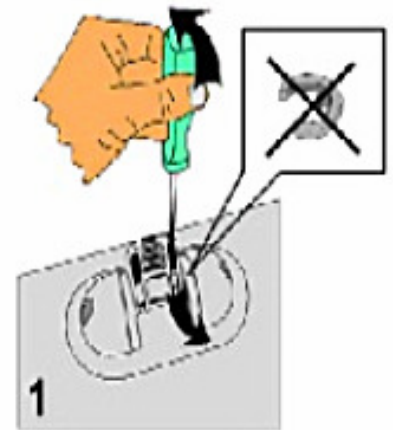

- 2) Slide the axis out of the rowlock support until the oarlock receiver can be removed.

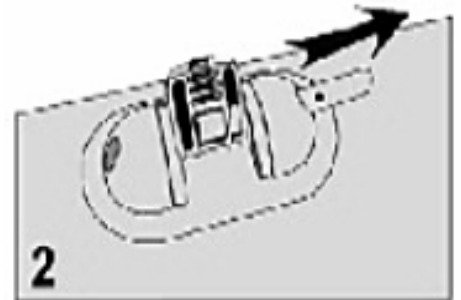

- 3) Remove and discard the original oarlock receiver.  
Clean complete rowlock support if needed.

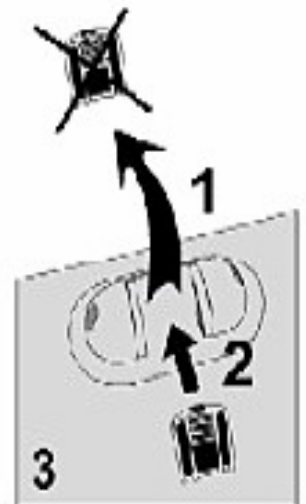

- 4) Install the oarlock retainer onto the receiver as shown.

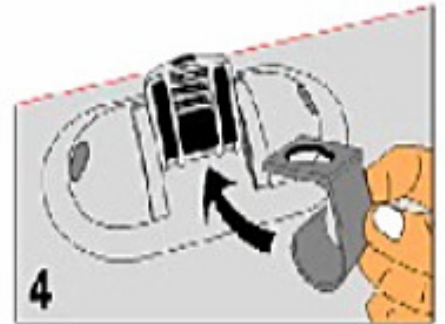

- 5) Slide the axis back into position.

**Note:** Be sure the new receiver is in the same position as the original receiver and that the oarlock retainer locks around the axis.



- 6) Install the new retaining clip onto the axis.

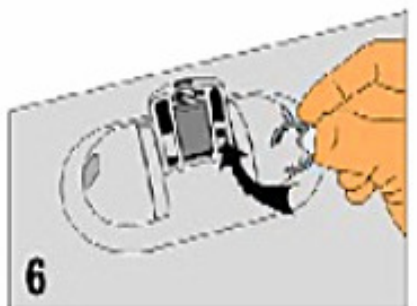

**Rowlock support retrofit is complete**

- A)** Feed locking tail of lifeline rope back out of the center.  
(Fig.1)

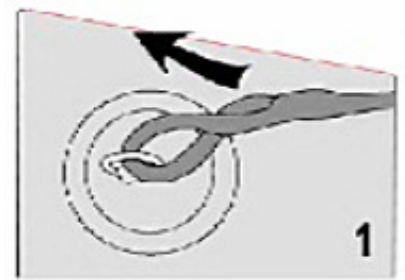

- B)** Pull the tail back through the center of the rope and out of the “D” ring. (fig.2)

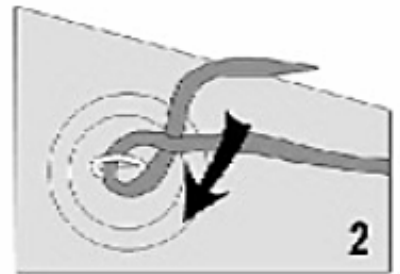

- C)** Pull the lifeline rope through the center (axis) of the rowlock support (fig.3)

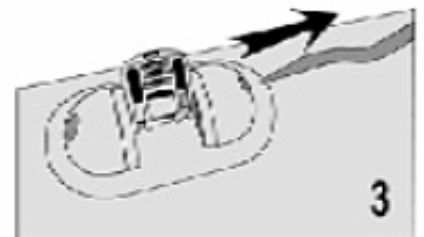

**Proceed with step 1) of retrofit instructions.**

- D)** Feed the end of the lifeline rope through the axis of the rowlock support. (fig.4)



**E)** Pass the end through the “D” ring.  
(fig.5)

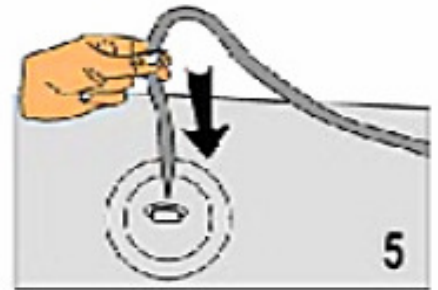

**F)** Pass the end through the center of itself (the lifeline rope) using the original passage if possible. (fig.6)

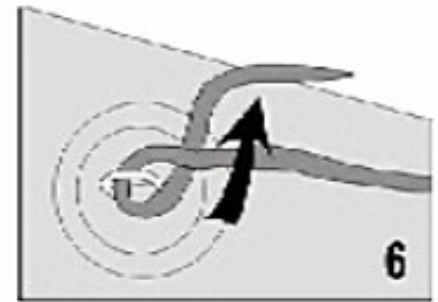

**G)** Feed the tip of the end into the center of the lifeline ropes core, while gathering the outer area to make passage easier. Continue feeding into center until a tight, uniform loop is made. (fig.7&8)

